

U:\222706059\vd\_working\_files\04\_architecture\01\_cad\01\_reflected\va31  
2025.10.15 9:54:35 AM



**A1 REFLECTED CEILING PLAN**  
SCALE: 1/8" = 1'-0"



**A4 REFLECTED CEILING PLAN - STORAGE BLDG**  
SCALE: 1/8" = 1'-0"

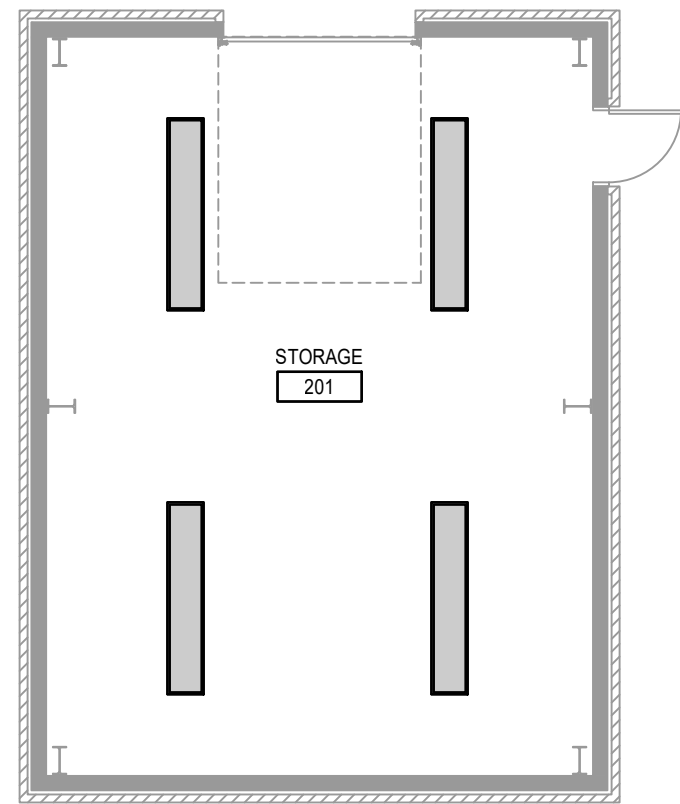

**CEILING PLAN LEGEND**

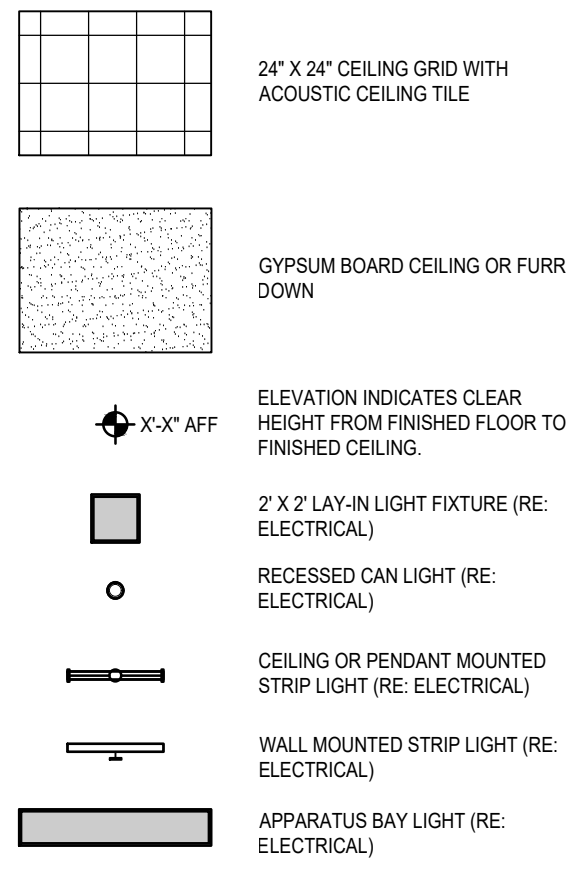

**GENERAL RCP NOTES**

- THIS PLAN IS FOR LOCATION OF LIGHT FIXTURES AND OTHER CEILING PLAN ELEMENTS ONLY. REFER TO ENGINEERING DRAWINGS ADDITIONAL INFORMATION INCLUDING SWITCHING, CIRCUITING, AND LIFE SAFETY EQUIPMENT.
- LAY IN CEILINGS SHALL BE INSTALLED CENTERED IN THE ROOM, EACH WAY, UNLESS NOTED OTHERWISE.
- TYPICAL CEILING HEIGHT IS 9'-0" A.F.F. UNLESS NOTED OTHERWISE.
- LIGHT FIXTURES ARE DIMENSIONED TO CENTERLINE OF FIXTURE, UNLESS NOTED OTHERWISE.
- DISCREPANCIES BETWEEN ARCHITECTURAL AND ENGINEERING DRAWINGS OR BETWEEN THE DRAWINGS AND FIELD CONDITIONS SHALL BE CLARIFIED WITH THE ARCHITECT BEFORE PROCEEDING WITH INSTALLATION.
- ALL FIXTURES SHALL BE INSTALLED IN CENTER OF CEILING TILE UNLESS NOTED OTHERWISE. DISCREPANCIES WITH LIGHT FIXTURES, SWITCHES, THERMOSTATS, OR DIFFUSERS AS TO LOCATION BETWEEN ARCHITECTURAL AND ENGINEERING DRAWINGS OR BETWEEN THE DRAWINGS AND FIELD CONDITIONS SHALL BE CLARIFIED WITH THE ARCHITECT BEFORE PROCEEDING WITH INSTALLATION.
- FINAL SPRINKLER HEAD LOCATIONS TO BE COORDINATED WITH DESIGN-BUILD SUBCONTRACTOR. HEADS TO BE CENTERED IN GRID CEILINGS AND ALIGNED IN HARD CEILINGS.
- SPACE GYPSUM BOARD CONTROL JOINTS 30'-0" O.C. MAXIMUM. VERIFY FINAL LOCATION WITH ARCHITECT PRIOR TO INSTALLATION.
- COMBUSTIBLE BULKHEAD FRAMING ENCLOSING RETURN AIR PLENUMS SHALL BE COVERED WITH FIRE TAPED GYPSUM DRYWALL ON INTERIOR BULKHEAD SURFACES UP TO THE RATED DRYWALL CEILING AT THE BOTTOM OF THE STRUCTURAL FLOOR OR ROOF FRAMING ABOVE. FURRED CEILING ENCLOSING RETURN AIR PLENUMS SHALL BE CONSTRUCTED USING A SUSPENDED LIGHT GAGE METAL DRYWALL CEILING SYSTEM. NO COMBUSTIBLE MATERIALS ARE TO BE EXPOSED INSIDE RETURN AIR PLENUM SPACES. REFER TO MECHANICAL PLANS.
- IN TYPE III AND V CONSTRUCTION, ALL FURRED DRYWALL CEILINGS NOT ENCLOSING RETURN AIR PLENUMS OR RATED SHAFTS MAY AT THE CONTRACTOR'S OPTION, BE CONSTRUCTED USING SUSPENDED WOOD FRAMING MEMBERS OR A LIGHT GAGE METAL CEILING SUSPENSION SYSTEM. FRAMING MEMBERS AT FURRED CEILINGS SHALL BE PROVIDED AT NOT MORE THAN 24" ON CENTER, WOOD FRAMING, IF USED, SHALL BE SUSPENDED AND SUPPORTED FROM STRUCTURAL FLOOR OR ROOF FRAMING AT NOT MORE THAN 4'-0" ON CENTER. REFER TO MECHANICAL PLANS.
- ALL DUCT WORK TO BE HELD AS HIGH & TIGHT AS POSSIBLE TO BOTTOM OF ROOF OR FLOOR STRUCTURE. DUCT TO BE SUPPORTED FROM TOP ROOF JOIST AND GIRDER CHORDS.
- DO NOT SUSPEND ANY ITEMS FROM HORIZONTAL BRIDGING OR X-BRACING, OR PIPING AND CONDUITS OR ANY WORK BY OTHER TRADES.
- UNLESS OTHERWISE INDICATED, EACH SUBCONTRACTOR AND GENERAL CONTRACTOR IS RESPONSIBLE FOR ADEQUATELY BRACING AND SUPPORTING ALL ITEMS FROM THE ROOF STRUCTURE FOR GRAVITY LOADS AND TO RESIST SEISMIC MOVEMENTS AS REQUIRED BY ALL APPLICABLE CODES. ANY BRACING WITH SIGNIFICANT VISUAL IMPACT IS SUBJECT TO ARCHITECT REVIEW AND APPROVAL.
- ALL MAIN AND BRANCH SPRINKLER LINES ARE TO BE RUN WITHIN THE ROOF STRUCTURE SPACE WHEREVER POSSIBLE. WHEN LINES ARE RUN BELOW ROOF STRUCTURE, THEY ARE TO BE HELD AS HIGH AND TIGHT AS POSSIBLE TO BOTTOM OF STRUCTURE. ALL LINES ARE TO BE SUSPENDED FROM TOP JOIST AND GIRDER CHORDS.

Consultant

Design Phase Acceptance

Permit/Seal



Client/Project  
**CITY OF NATCHITOCHES**

**NEW FIRE STATION NO. 3**

NATCHITOCHES, LOUISIANA

Project No.: 222706059

File Name: A131

Scale: AS INDICATED

Dwn. Dgn. Chkd. 2025.09.26  
YYYY.MM.DD

Title  
**REFLECTED CEILING PLAN**

Revision: Sheet: of  
Drawing No.

**A131**



Stantec (Formerly Rodley-Blevins & Associates)  
1200 Brickyard Lane, Suite 400  
Baton Rouge, LA 70802  
Tel: 225-765-7400  
www.stantec.com

Copyright Reserved

The Contractor and user, and be responsible for all dimensions. DO NOT scale the drawings. The Contractor and user, and be responsible for all dimensions. DO NOT scale the drawings. The Contractor and user, and be responsible for all dimensions. DO NOT scale the drawings.